

**Please, read this manual  
carefully before use!**

**Owner's Manual**



EN

## **Gasoline tractor lawn mower**

**KS 98TMG-H**

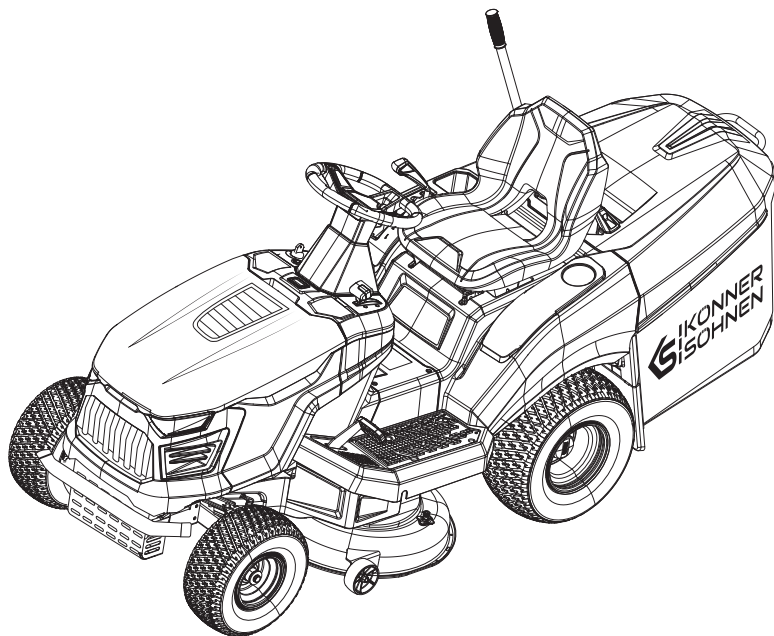



Fig. 4

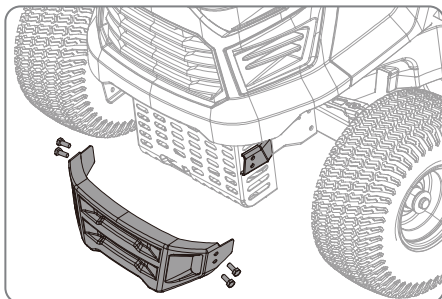

Fig. 5

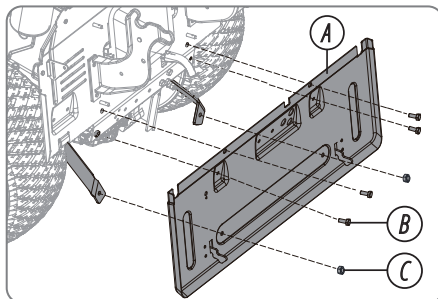

Fig. 6

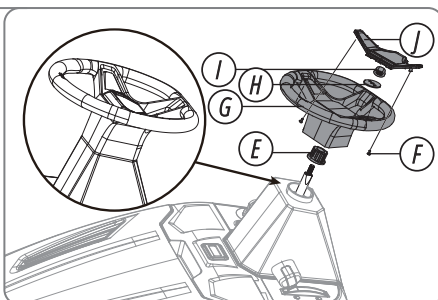
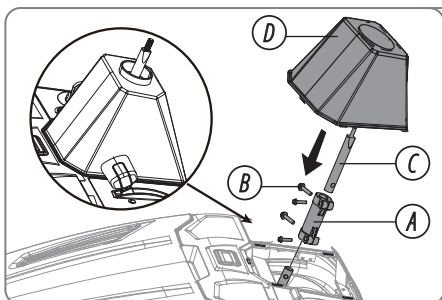

Fig. 7

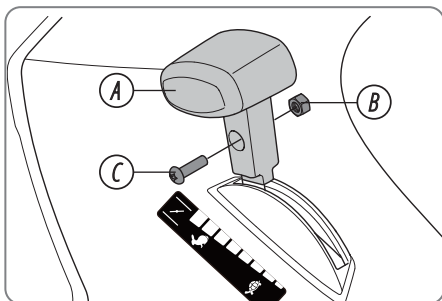

Fig. 8

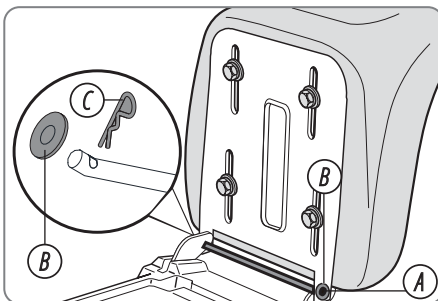

Fig. 9

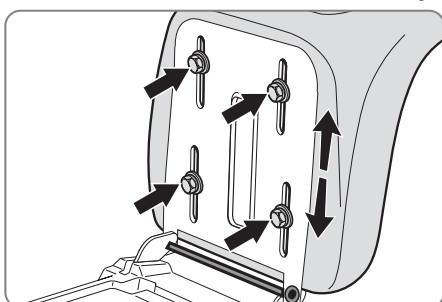

Fig. 10

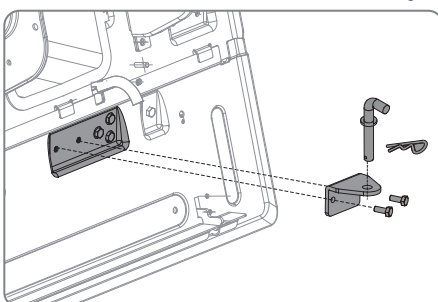



Fig. 11

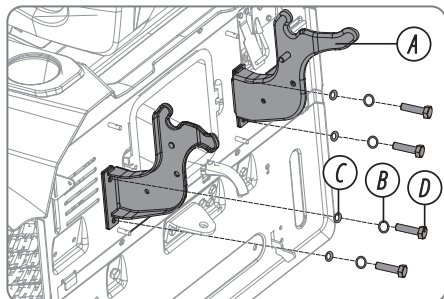

Fig. 12

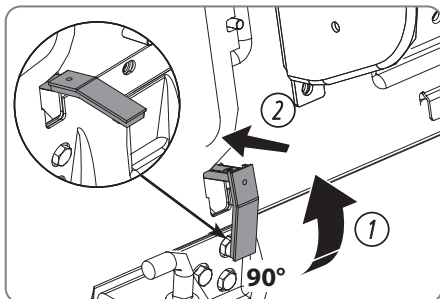

Fig. 13

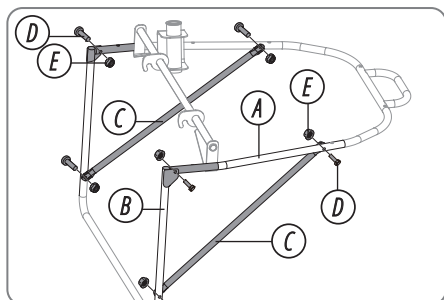

Fig. 14

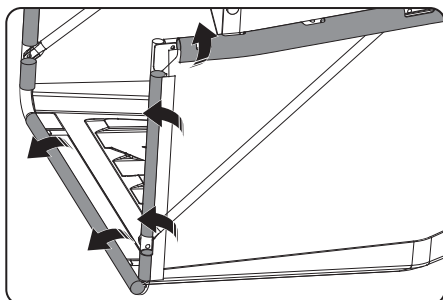

Fig. 15

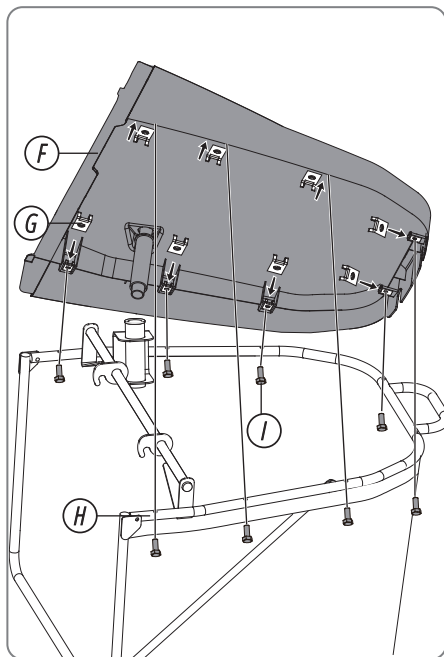

Fig. 16

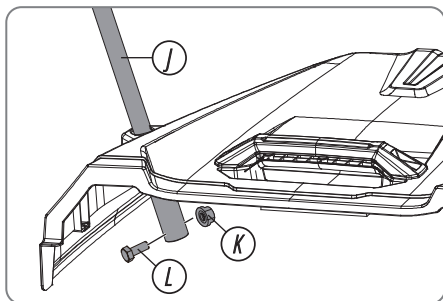
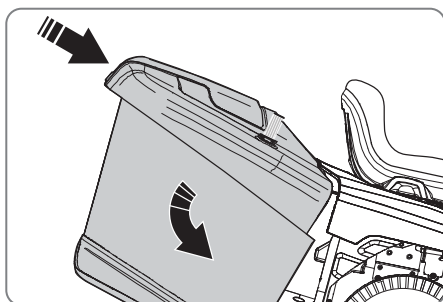

Fig. 17





OPTIONAL ACCESSORY ASSEMBLY AND FUNCTIONS

Fig. 18

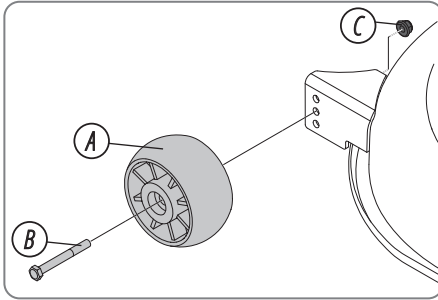

Fig. 19

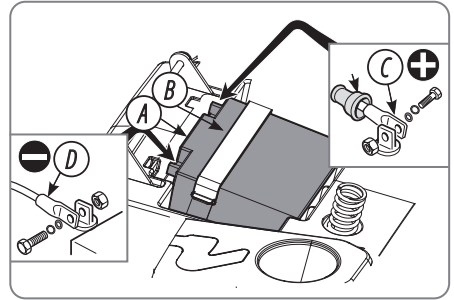

Fig. 20

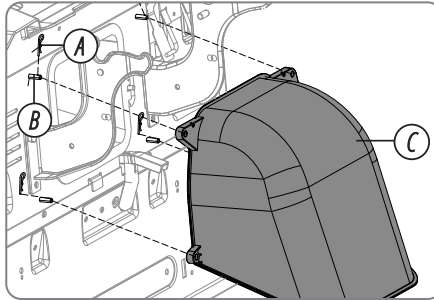
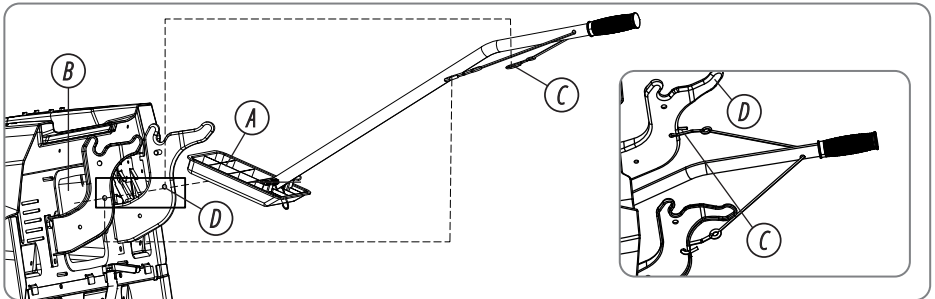

Fig. 21





Thank you for choosing **Könnér & Söhnen®** products. This manual provides a brief description of safety requirements, setup procedures, and operating instructions. More information is available in the support section at: [konner-sohnen.com/pages/instructions](http://konner-sohnen.com/pages/instructions)

You can also download the manual by scanning the QR code or by visiting the official importer's website at [www.konner-sohnen.com](http://www.konner-sohnen.com)



*Please, read this manual  
carefully before use!*

The manufacturer reserves the right to make changes that may not be reflected in this manual, including:

- The manufacturer reserves the right to make changes in the product design, configuration and construction.
- The images and drawings in this manual are for reference only and may differ from the actual components and inscriptions on the products.

Contact information that you are free to use in case of any problems can be found at the end of this manual. All information in this manual is correct to the best of our knowledge at the time of publication. The current list of service centers can be found on the official importer's website at [www.konner-sohnen.com](http://www.konner-sohnen.com)



**ATTENTION – DANGER!**



**Failure to follow the recommendations marked with this sign may lead to serious injury or death of the operator or third parties.**



**IMPORTANT!**



**Useful information while operating the machine.**

## PRODUCT DESCRIPTION

1

This is a lawn mower with the cutting head mounted between the front and rear axle. It is equipped with a 4-stroke gasoline engine.

### PRODUCT PURPOSE

This product is used solely for mowing grass in private gardens or on private garden slopes with a maximum incline of 10°. It should not be used in public parks, on sports fields, in agriculture, or forestry. Attach an optional accessory to use the product for other tasks. Use the product only with accessories supplied by the manufacturer. For additional information, please contact service distributor.

Using the product for other purposes is considered improper use. This will void the warranty and relieve the manufacturer of any responsibility for damages caused to the user or third parties.

Consult local regulations related to the operation of lawn mowers.

## IMPORTANT SAFETY INFORMATION

2

### 2.1 GENERAL SAFETY INSTRUCTIONS



**WARNING!**



**Do not continue to use a product with damaged cutting equipment. Damaged cutting equipment can throw objects and cause serious injury or death. Replace damaged blades immediately.**



**WARNING!**



**This product produces an electromagnetic field during operation. This field may under some circumstances interfere with active or passive medical implants. To reduce the risk of serious or fatal injury we recommend persons with medical implants to consult their physician and the medical implant manufacturer before operating this product.**

- Always be careful and use your common sense. Avoid all situations which you consider to be beyond your capability. If you feel uncertainty about the operating procedures after you read the operator's manual, consult an expert before you continue.
- Read and understand the operator's manual and the instructions on the product carefully before you start the product.
- Learn how to use the product and its controls safely and learn how to stop the product quickly.
- Learn to recognize the safety decals.
- Keep the product clean to make sure that you can clearly read signs and stickers.
- Clean fuel or oil spillage on the product before you operate the product and before you put the product in storage.
- Keep in mind that the operator will be held responsible for accidents that involve other persons or their property.
- Do not put hands or feet near parts that rotate.
- Do not put hands or feet below the product.
- Keep away from the discharge opening at all times.
- Always stop the blades when you operate the product on gravel surfaces.
- Do not operate the cutting deck if the grass catcher, discharge chute, or other safety devices are missing or defective.
- Always disengage the blades when you do not mow.
- Make sure that grass or other unwanted materials cannot touch muffler or hot parts of the engine.
- Do not use the cutting deck to collect foreign material that may cause blockage of the discharge opening.
- Do not transport passengers. The product must only be used by one person.
- Do not let the product stay unsupervised with the engine on. Always stop the blades, apply the parking brake, stop the engine and remove the ignition key before you let the product stay unsupervised.
- Only use the product in daylight or in other well-lit conditions. Keep the product at a safe distance from holes or other irregularities in the ground. Look out for other possible risks.
- Do not use the product in bad weather, for example in fog, in rain, moist or in wet locations, strong winds, intense cold, risk of lightning, etc.
- Find and mark stones and other fixed objects to prevent collision.
- Clear the area of objects such as stones, toys, wires, etc. that may become caught in the blades and be thrown out.
- Do not let children or other persons not approved for operation of the product to use or do servicing on it. Local laws may regulate the age of the user.
- Make sure that nobody else is in the vicinity of the product when you start the engine, engage the drive or start to move the product.
- Keep an eye on the traffic when you mow near a road or move across a road.
- Do not use the product if you are fatigued, while under the influence of alcohol or drugs, medicine or anything that can have a negative effect on your vision, alertness, coordination or judgement.
- Be careful when you put the product on a trailer or a truck and when you remove the product from a trailer or truck.
- Always park the product on a level surface with the engine stopped.
- Stop the engine and make sure that all parts have stopped before you clean or do maintenance on the product.
- Stop the engine and make sure that all parts have stopped before you remove the grass catcher or remove blockage in the discharge chute.
- Let the product become cool before you put it in storage.

## 2.2 SAFETY INSTRUCTIONS REGARDING CHILDREN

- Keep children away from the area to be mowed. Make sure that an adult is responsible for the children.
- Keep an eye out and stop the product if children enter the work area. Be very careful near corners, bushes, trees or other objects that prevents a clear view.
- Before and while you move the product in reverse, look behind you and look down to make sure there are no small children in the vicinity of the product.
- Do not let children ride along. They can fall off and get seriously injured or prevent safe maneuvering of the product.
- Do not let children operate the product.

## 2.3 SAFETY INSTRUCTIONS FOR OPERATION



**WARNING!**



**Do not touch the engine or exhaust system during or directly after operation. The engine and the exhaust system become very hot during operation. Risk of burn injuries, fire and damage to property or adjacent areas. When you operate the product, keep away from bushes and other objects.**

- Always look down and behind you before and while you move in reverse. Look out for large and small obstacles.
- Decrease the speed before you turn around a corner.
- Stop the blades when you move across areas that you do not cut.
- Before you operate the product, clear the cold air intake of the engine from grass and dirt. If the cold air intake is blocked, there is a risk of engine damage.
- Move around stones and other larger objects carefully and make sure that the blades do not hit the objects.
- Do not operate the lawn mower with the blades engaged over foreign objects. Stop and examine the product and cutting deckhit a foreign object. If it is necessary, make repairs before you restart.

## 2.4 PERSONAL PROTECTIVE EQUIPMENT

- Use approved personal protective equipment when you use the product. Personal protective equipment cannot fully prevent injury but it decreases the degree of injury if an accident does occur. Let your dealer help you select the right equipment.
- Use approved hearing protection. Long-term exposure to noise can result in permanent hearing impairment.
- Use heavy-duty slip-resistant boots or shoes. Steel toes are recommended. Do not use open shoes or go with bare feet.
- Use protective gloves when necessary, for example when you attach, examine or clean the cutting equipment.
- Do not wear loose-fitting clothing, jewelry or other items that can get caught in moving parts.
- Keep first aid equipment and fire extinguisher near.

## 2.5 SAFETY DEVICES ON THE PRODUCT

- Do not use a product with safety devices that are damaged or do not operate correctly. Do a check of the safety devices regularly. If the safety devices are damaged, speak to your service agent.
- Do not make modifications on safety devices. Do not use the product if protective plates, protective covers, safety switches or other protective devices are not attached or are damaged.

### To do a check of the ignition lock:

- Start and stop the engine to do a check of the ignition lock. [Refer to chapter 8.1 and 8.9.](#)
- Make sure that the engine starts when you turn the ignition key to the start position (Fig. 1).
- Make sure that the engine stops immediately when you turn the ignition key to the stop position (0).

### To do a check of the reverse operation system (ROS):

If the reverse operation system (ROS) does not operate correctly, speak to an approved service agent.

1. Start the product. [Refer to chapter 8.1.](#)
2. Engage the cutting deck. [Refer to chapter 8.5.](#)

- With the ignition key in the on position (A), push down on the rearward pedal (Fig. 2). The engine must stop when you push down on the rearward pedal.
- Start the product and engage the cutting deck again.
- Turn the ignition switch to the ROS on position (B), (Fig. 2).
- With the ignition key in the ROS on position, push down on the rearward pedal. The engine must not stop when you push down on the rearward pedal.



Fig. 1

## 2.6 OPERATION CONDITIONS

These conditions are necessary to start the engine:

- The parking brake is applied.
- The drive of the blades is disengaged.
- The forward pedal and the rearward pedal are in their neutral position.

The engine must stop in these situations:

- The parking brake is not applied and the operator lifts from the seat.
- The cutting deck is engaged and the operator lifts from the seat.
- The cutting deck is engaged and the rearward pedal is pushed down but the ROS is disengaged.

The drive of the blades must stop in these situations:

- The parking brake is applied and the operator lifts from the seat.
- The PTO button is pushed in.
- The grass catcher or other accessory is removed.

Try to start the engine without one of the conditions. Change the conditions and try again. Do this check daily.

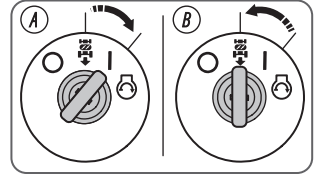

Fig. 2

## 2.7 TO DO A CHECK OF THE FORWARD PEDAL AND REARWARD PEDAL

- Start the product. [Refer to chapter 8.1.](#)
- Make sure that the forward pedal and rearward pedal are not blocked and can be operated freely.
- Slowly push the forward pedal to move forward.
- Release the forward pedal to brake. Make sure that the brake engages when the forward pedal is released.



NOTE



**The product has an automatic brake that engages when you release the pedals.**

- Do the same procedure for the rearward pedal.
- Make sure that the product does not move when the pedals are in their neutral position.

## 2.8 PARKING BRAKE



WARNING!



**If the parking brake does not work, the product can start to move and cause injury or damage. Make sure that the parking brake is regularly examined and adjusted. [Refer to chapter 9.10.](#)**

## 2.9 MUFFLER

The muffler keeps the noise levels to a minimum and sends the exhaust fumes away from the operator. Do not use the product if the muffler is missing or damaged. A damaged muffler increases the noise level and the risk of fire.



WARNING!



**The muffler becomes very hot during and after use and when the engine operates at idle speed. Be careful near flammable materials and/or fumes to prevent fire.**

## To do a check of the muffler

Examine the muffler regularly to make sure that it is attached correctly and not damaged.

## 2.10 PROTECTIVE COVERS

Missing or damaged protective covers increase the risk of injury on moving parts and hot surfaces. Do a check of the protective covers before you operate the product. Make sure that the protective covers are correctly attached and do not have cracks or other damages. Replace damaged covers.

## 2.11 TO CUT GRASS ON SLOPES

- To cut grass on slopes increases the risk that you can not control the product and that it overturns. This can cause injury or death. It is necessary to cut the grass carefully on all slopes. If you cannot reverse up a slope or if you do not feel safe, do not cut it.
- Remove stones, branches and other obstacles.
- Cut up and down the slope, not from side to side.
- Do not operate the product on ground that slopes more than 10°.
- Do not start or stop on a slope.
- Move smoothly and slowly on slopes.
- Do not make sudden changes in speed or direction.
- Do not turn more than necessary. Turn slowly and gradually when you move down a slope. Move at low speed. Turn the wheel carefully.
- Look out for and do not move across furrows, holes and bumps. There is a higher risk that the product overturns on ground that is not flat. Long grass can hide obstacles.
- Do not cut grass near edges, ditches or banks. The product can suddenly overturn if a wheel moves across the edge of a steep slope or a ditch, or if an edge gives way. If the product falls into water, there is a risk of drowning.
- Do not cut wet grass. It is slippery, and tires can lose their grip so that the product skids.
- Do not put your foot on the ground to try to make the product more stable.
- Move very carefully if an accessory or other object is attached that can make the product less stable.
- Follow the manufacturer's recommendations for wheel weights or counterweights.

## 2.12 TOW SAFETY

- Use the tow bar to attach the equipment.
- Do not tow equipment that is heavier than the maximum permitted tow equipment weight.
- Make sure that no other persons are near the product when you tow equipment. [Refer to chapter 5.](#)
- Be careful when you tow equipment on slopes or rough ground.
- Operate the product at low speed when you tow equipment.

## 2.13 FUEL SAFETY



**WARNING!**



**Be careful with fuel. It is very flammable, and can cause injury and damage to property.**

- Do not fill the fuel tank indoors.
- Gasoline and gasoline fumes are poisonous and very flammable. Be careful with gasoline to prevent injury or fire.
- Do not remove the fuel tank cap or fill the fuel tank when the engine is on.
- Let the engine become cool before you refuel.
- Do not smoke when you fill fuel.
- Do not fill fuel near sparks or naked flames.
- If there are leaks in the fuel system, do not start the engine until the leaks are repaired.
- Do not fill above recommended fuel level. The heat from the engine and the sun makes the fuel expand and the fuel overflows if the tank is filled too much.
- Do not fill too much. If you spill fuel on the product, clean up the spill and wait until it is dry before you start the engine. If you spill on your clothing, change it.

- Store fuel in approved containers only.
- Store the product and fuel in such a way that there is no risk that fuel leaks or fumes can cause damage.
- Drain off the fuel in an approved container outdoors and away from naked flames.

## 2.14 TRANSPORT SAFETY

- Use an approved transport vehicle for transportation of the product.
- The product is heavy and can cause crush injuries. Be careful when you load it onto or off a vehicle or trailer.
- A markets national or local regulations can set limit to the transportation of the product.
- The operator of the transport vehicle is responsible to attach the product safely during transport. [Refer to chapter 10.2.](#)

## 2.15 BATTERY SAFETY



**WARNING!**



**A damaged battery can cause an explosion and cause injury. If the battery has a deformation or is damaged, speak to an approved service agent.**

- Use protective glasses when you are near batteries.
- Do not wear watches, jewelry or other metal objects near the battery.
- Keep the battery out of reach for children.
- Charge the battery in a space with good airflow.
- Keep flammable materials at a minimum clearance of 1 m when you charge the battery.
- Discard replaced batteries. [Refer to chapter 10.4.](#)
- Explosive gases can come from the battery. Do not smoke near the battery. Keep the battery away from open flames and sparks.

## 2.16 SAFETY INSTRUCTIONS FOR MAINTENANCE



**WARNING!**



**The product is heavy and can cause injury or damage to property or the adjacent area. Do not do maintenance on the engine or the cutting deck without these conditions:**

- The engine is off.
- The product is parked on a level surface.
- The parking brake is applied.
- The ignition key is removed.
- The cutting deck is disengaged.
- The ignition cable is removed from the plug.



**WARNING!**



**The exhaust fumes from the engine contain carbon monoxide, an odourless, poisonous and very dangerous gas. Do not run the product in closed spaces or spaces with not sufficient air flow.**













- For best performance and safety, do maintenance on the product regularly as given in the maintenance schedule. [Refer to chapter 9.](#)
- Electrical shocks can cause injuries. Do not touch the cables when the engine is on. Do not do a function test on the ignition system with your fingers.
- Do not start the engine if the protective covers are removed. There is a high risk of injury caused by moving or hot parts.
- Let the product become cool before you do maintenance near the engine.
- The blades are sharp and can cause cuts. Wind protection around the blades or use protective gloves when you do work on the blades.
- Do not park the product near the edge of a ditch or slope to get access to the cutting deck.
- Do not turn over the engine if the spark plug or ignition cable is removed.
- Make sure that all nuts and bolts are tightened correctly and that the equipment is in good condition.

- Do not change the adjustment of governors. If the engine speed is too high, the product components can become damaged. *Refer to chapter 5 "Engine speed"*.
- The product is approved only with the equipment supplied or recommended by the manufacturer.

## SYMBOLS

## 3

The rating plate on your tool may show symbols. These represent important information about the product or instructions on its use.

	WARNING: This product can be dangerous and cause serious injury or death to the operator or others. Be careful and use the product correctly.
	Read all safety warnings and all instructions. Failure to follow the warnings and instructions may result in fire and/or serious injury.
	Wear protective equipment. Basically, wear protective goggles, ear protection, safety boots with anti-slip soles.
	Choke.
	Fast/Slow.
	Turn on the drive system.
	Turn off the drive system.
	Engine OFF/ Engine ON.
	Engine start.
	Parking brake.
	Cutting height.
	Reverse operation system (ROS).
	Reverse/Forward.

	Work lights ON/OFF.
	Fuel.
	Max. ethanol 10%.
	Motor oil.
	Blades off/Blades on.
	Do not reach into the rotating area with your hands.
	Keep your hands and feet away from rotating blades. It may cut your hands and feet.
	Beware of objects being thrown up keep a safe distance and keep other people away.
	Do not operate the lawnmower on excessively steep slopes. MAX 10°
	Never carry passengers on the product or equipment.
	Keep children at a distance of no less than 10m from the work area.
	No step.
	Before and during maintenance, the engine should be turned off and the spark plug cap should be removed.
	Noise emission to the environment label as per EU and UK directives and regulations, and New South Wales legislation "Protection of the Environment Operations (Noise Control Regulation 2017". <i>The guaranteed sound power level of the product is specified in chapter 5 and on the label.</i>
	Apply and release the parking brake.



NOTE



Other symbols/decals on the product refer to market specific legal requirements.

### 3.1 PRODUCT DAMAGE

We are not responsible for damages to our product if:

- The product is incorrectly repaired.
- The product is repaired with parts that are not from the manufacturer or not approved by the manufacturer.
- The product has an accessory that is not from the manufacturer or not approved by the manufacturer.
- The product is not repaired at an approved service center or by an approved authority.

### 3.2 EURO V EMISSIONS



**WARNING!**



**Tampering with the engine voids the EU type-approval of this product.**

## MAIN OVERVIEW

4

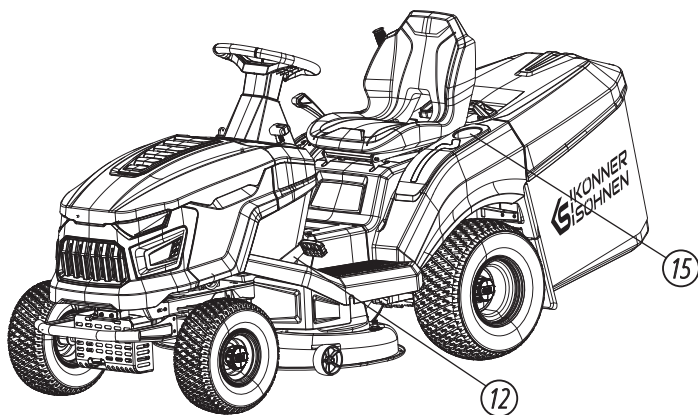
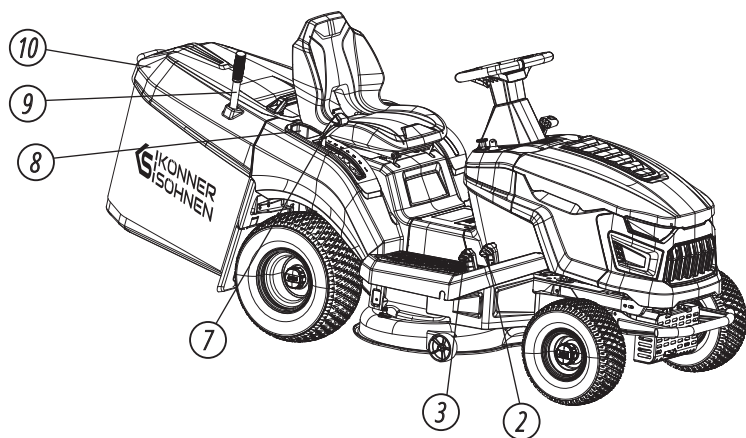

**IMPORTANT!**



**Manufacturer reserves the right to make changes and/or improvements in design, components set and technical attributes without notice and without incurring obligation. The pictures in this manual are schematical and may not match the parameters of original product.**

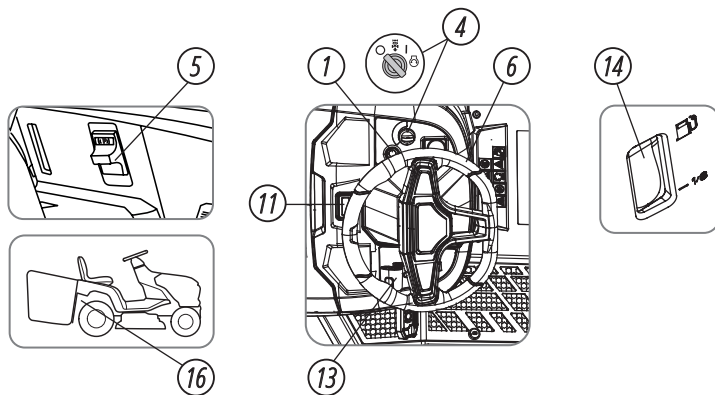

- |                         |  |
|-------------------------|--|
| 1. Light switch         | 9. Grass catcher handle                    |
| 2. Forward pedal        | 10. Grass catcher                          |
| 3. Reverse pedal        | 11. Hour meter                             |
| 4. Ignition lock        | 12. Parking brake pedal                    |
| 5. Parking brake        | 13. Air choke and engine speed control     |
| 6. Steering wheel       | 14. Fuel observation window                |
| 7. Cutting height lever | 15. Water cup holder                       |
| 8. Miscellaneous slot   | 16. Lever to engage or disengage the drive |

#### 4.1 OPERATOR PRESENCE CONTROL (OPC)

The OPC engages when the operator lifts from the seat. The OPC disengages the drive of the blades. The OPC stops the engine if the parking brake is not applied.

#### 4.2 GRASS CATCHER PRESENCE CONTROL

The product has a grass catcher presence control that engages when a grass catcher or other accessory is installed. The blades stop if the grass catcher or other accessory is removed. [Refer to chapter 2.6.](#)

#### 4.3 WORK LIGHT

The product has work light. Push the power switch to make the work light come on or go off (fig. 3).

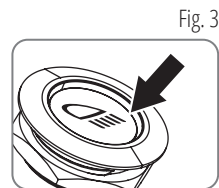

Model	KS 98TMG-H
<b>DIMENSIONS</b>	
Wheel base	1170 mm
Track width, front	900 mm
Track width, rear	900 mm
Tire pressure, front	1.5 bar
Tire pressure, rear	1.8 bar
Max. tow equipment weight, at 10° gradient	100 kg
Front tires	15×600-6
Rear tires	18×850-8
Max. permitted vertical force on the tow bar	250/25 N/kg
Max. permitted horizontal force on the tow bar	250/25 N/kg
Maximum mowing slope angle	10°
Vehicle dimensions, including cutterhead, grass box, (L×W×H)	2360×1040×1100 mm
Net weight	200 kg
<b>ENGINE</b>	
Engine model	DV452
Engine output	9.2 kW/12.5 hp
Engine speed	2800 rpm
Cylinder	1/cast-iron sleeve
Engine cylinder volume	452 cm <sup>3</sup>
Fuel tank volume	7.5 l
Start motor	Electric start, 12V
Crank case volume	1.2 l
Fuel, lead-free, max ethanol/min. octance grade	E10/92
Oil	SAE 15W40-SJ (-15°C SAE 10W40-SJ)
<b>ELECTRICAL SYSTEM</b>	
Battery	12V, 18Ah
Spark plug	F7TC/F7RTC
Electrode gap	0.7–0.8 mm
<b>CUTTING DECK</b>	
Cutting width	980 mm
Cutting height	30–90 mm, 7 positions
Blade engagement	electromagnetic blade activation
Water connection	quick-connect coupling
Collection bag	245 l

TRANSMISSION	
Type	hydrostatic, HYDRO-GEAR®/T2-ADBF-2X3C-1RX1
MAX Speed forward	9 km/h
MAX Speed reverse	5 km/h
NOISE EMISSIONS	
Measured sound power level, Lwa	97.96 dB(A)
Guaranteed sound power level, Lwa	99 dB(A)
SOUND LEVELS	
Sound pressure level at operator's ear, Lpa	86.3dB(A)
VIBRATION LEVELS	
Whole-body vibration	1.263 m/s <sup>2</sup>
Hand-arm vibration	2.866 m/s <sup>2</sup>
Uncertainty K	1.5 m/s <sup>2</sup>

## ASSEMBLY INSTRUCTIONS (PICTURES AT THE BEGINNING OF THE INSTRUCTIONS)

6

### 6.1 INSTALL THE BUMPER (see Assembly instructions, Fig. 4)

Attach the bumper to the bumper bracket with four M8 bolts and tighten.

### 6.2 INSTALL THE GRASS CATCHER COVER PLATE (see Assembly instructions, Fig. 5)

Install the grass catcher cover plate (A) on the frame using four M8 bolts (B) and two nuts (C), and tighten.

### 6.3 TO INSTALL THE STEERING WHEEL (see Assembly instructions, Fig. 6)

1. Insert the fixed sleeve (A).
2. Insert the direction extension rod (C) into the center of the fixed sleeve (A); secure the direction extension rod and the fixed sleeve with four M8 bolts (B).
3. Snap the cover (D) onto the machine.
4. Install the steering shaft limit (E), steering wheel (G), and washer (H) on the steering extension rod (C) in sequence, and secure them with an M12 nut (I), tightening the nut to 24Nm.
5. Use two screws (F) to secure the steering wheel trim cover (J) to the steering wheel.

### 6.4 TO INSTALL THE KNOB ON THE THROTTLE CONTROL (see Assembly instructions, Fig. 7)

1. Put the knob (A) onto the throttle control lever.
2. Install the nut (B) and the screw (C).

### 6.5 TO INSTALL THE SEAT (see Assembly instructions, Fig. 8)

1. Insert a washer (B) onto the end of shaft (A), then insert shaft (A) sequentially into the seat assembly and the seat mounting hole;
2. Insert a washer (B) onto shaft (A) and then insert a cotter pin (C) into the hole in shaft (A) to secure it.

### 6.6 TO ADJUST THE SEAT (see Assembly instructions, Fig. 9)

1. Fold the seat forward.
2. Loosen the four fixing bolts and slide it along the slots.
3. Move the seat until it is in a position where you can push the pedals down fully.
4. Tighten the bolt completely.

### 6.7 TO INSTALL THE TOW BAR (see Assembly instructions, Fig. 10)

- Install the tow bar with the 2 screws.
- Insert the trailer tongue into the trailer hitch and secure it with a cotter pin.

## 6.8 TO INSTALL THE BRACKETS FOR THE GRASS CATCHER (see Assembly instructions, Fig. 11)

Use four M8 bolts (D), four spring washers (B), and four washers (C) to secure the grass box bracket (A) to the vehicle frame.

## 6.9 ADJUST THE SWITCH FOR THE GRASS FULL MATERIAL (see Assembly instructions, Fig. 12)

Adjust the switch upwards by 90°, then move it forward to the bottom.

The grass collection switch has 5 positions, users can make reasonable adjustments according to their usage (pulling outwards makes it easier to trigger the switch).

## 6.10 TO ASSEMBLE THE GRASS CATCHER

1. Install the front frame (B) on the top frame (A), securing each side with a bolt (D) and a nut (E).
2. Install the side support rod (C) on the front frame (B) and the top frame (A), securing each side with two bolts (D) and nuts (E), see Assembly instructions, fig. 13.
3. Attach the rubber tube elements to the front frame, see Assembly instructions, fig. 14.
4. Insert the bolt clip (G) into the grass box lid (F), and secure the grass box lid (F) to the grass box frame (H) with eight bolts (I), see Assembly instructions, fig. 15.
5. Install the screw (L) and the nut (K) in the tube of the grass catcher handle (J), see Assembly instructions, fig. 16.

## 6.11 TO INSTALL AND REMOVE THE GRASS CATCHER

1. Tilt the grass catcher and put it on the 2 brackets, see Assembly instructions, fig. 17.
2. Release the grass catcher and let it move into position. Make sure that the latches in the bottom lock the bottom part of the grass catcher in position.
3. To remove the grass catcher, move the grass catcher handle until the latches release the bottom of the grass catcher. Lift the grass catcher from the brackets.

## 6.12 TO INSTALL THE ANTI-SCALP WHEELS (see Assembly instructions, Fig. 18)

Install the anti-scalp wheel (A), the bolt (B), and the nut (C) in 1 of the 3 holes.

## 6.13 TO CONNECT THE BATTERY



**WARNING!**



**Risk of electric shock. Make sure that the ignition switch is in the off position and that the ignition key is removed.**

The battery (A) is installed under the seat and is secured by a belt (B).

1. First connect the red wire (C) to the positive pole (+) and then the black wire (D) to the negative pole (-), using the screws supplied, see Assembly instructions, fig. 19.
2. Apply silicone grease to the terminals and check that the protective cap for the red wire (E) is in place.



**IMPORTANT!**



**Always fully charge the battery. according to the instructions in the battery book-let.**



**IMPORTANT!**



**To prevent the safety device in the electronic circuit board from cutting in, never start the engine until the battery is fully charged!**

Fig. 20

### 7.1 TO FILL OIL (Fig. 20)

The lawn mower is transported free of motor oil. Do not start the engine until it is filled with sufficient amount of motor oil.

Fill the oil through the dipstick opening. Add the oil slowly. The recommended amount of oil for each model is indicated in the specification chart.

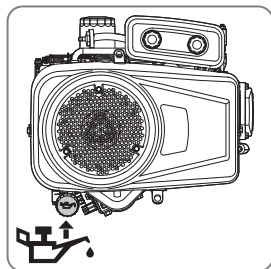

### 7.2 TO FILL FUEL



**WARNING!**



**Gasoline is very flammable. Be careful and refuel outdoors. Refer to chapter 2.13.**



**WARNING!**



**Do not use the fuel tank as a support area.**



**WARNING!**



**Incorrect type of fuel can result in engine damage.**

The engine runs on gasoline with a minimum octane rating of 91 RON (87 AKI), not mixed with oil. **Use only unleaded gasoline with an octane rating of 90–95 containing no more than 10% ethanol.**

- Do a check of the fuel level before each use and refuel if it is necessary.
- Do not fully fill the fuel tank. Keep a space of a minimum 2.5 cm.

Fig. 21

### 8.1 TO DO BEFORE YOU START THE PRODUCT

1. Do a check of the engine oil level. [Refer to chapter 9.23.](#)
2. Fill the fuel tank with fuel. [Refer to chapter 7.2.](#)
3. Turn the switch on the fuel tank cap to the “ON” position (Fig. 21).
4. Make sure that the drive system is engaged. [Refer to chapter 8.3.](#)
5. Put the cutting deck in the highest position. [Refer to chapter 8.6.](#)

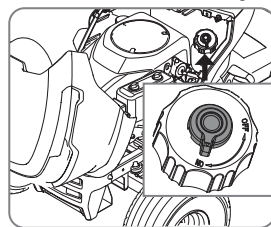

### 8.2 TO START THE ENGINE

1. Make sure that the cutting deck is disengaged. [Refer to chapter 8.5.](#)
2. Sit in the seat in work position.
3. Apply the parking brake. [Refer to chapter 8.4.](#)
4. Push the throttle control lever to position (A) to close the choke (Fig. 22).
5. Turn the ignition key to the start position. When the engine starts, immediately release the ignition key. The ignition key goes back to the “ON” (I) position (Fig. 23) automatically when you release it.



**WARNING!**



**Do not operate the starter for more than 5 seconds at a time. If the engine does not start, wait 15 seconds before you try again.**

6. After the machine starts, quickly push the throttle control lever to the full throttle (B) position.
7. Let the engine run at half throttle for 1 minute before applying heavy load.
8. Push the throttle control to the full throttle position (B), Fig. 24.



**WARNING!**



**The throttle control lever must not be set to position (C), Fig. 25. when adding load to the machine (such as mowing or walking), otherwise it is likely to stall.**

To engage the cutting deck when the engine is at full speed causes strain on the drive belts. Engage the cutting deck before you put the throttle control in the full throttle position.

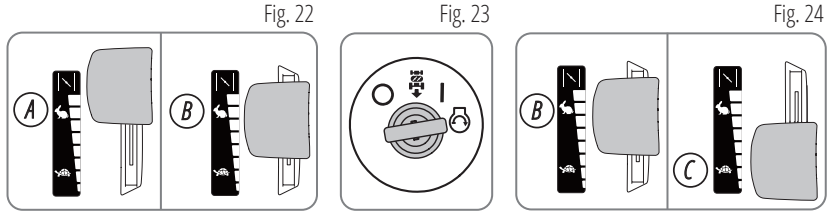

### 8.3 TO ENGAGE AND DISENGAGE THE DRIVE SYSTEM

To move the product with the engine off, the drive system must be disengaged.



**WARNING!**



**Make sure that you fully pull out or push in the lever. Do not use middle positions**

The lever to engage or disengage the drive system is found behind the right rear wheel (Fig. 25).

- Push the lever in fully to engage the drive system.
- Pull the lever out fully to disengage the drive system.

Fig. 25

### 8.4 TO APPLY AND RELEASE THE PARKING BRAKE

To apply the parking brake, do the steps that follow (Fig. 26):

- Push down the parking brake pedal (A) fully and pull up the parking brake lock (B).
- While holding the parking brake lock in the upper position, release the parking brake pedal.

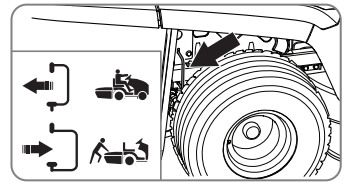

To release the parking brake, push down on the parking brake pedal and release it.

### 8.5 TO ENGAGE AND DISENGAGE THE CUTTING DECK (Fig. 27)

- Pull out the PTO button to engage the cutting deck.
- Push in the PTO button to disengage the cutting deck.



**WARNING!**



**Do not operate the cutting deck without a grass catcher or other accessory installed to the grass discharge.**

### 8.6 TO SET THE CUTTING HEIGHT (Fig. 28)

- Pull the cutting height lever in the direction of the seat and put it in 1 of the notches for the correct cutting height.

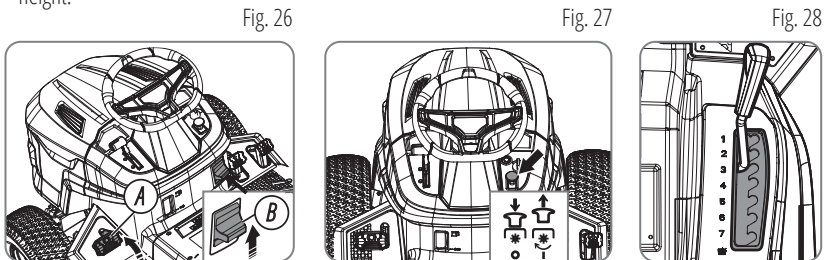

**8.7 TO OPERATE THE PRODUCT**

1. Start the engine. [Refer to chapter 8.2.](#)
2. Release the parking brake. [Refer to chapter 8.4.](#)
3. Carefully push the forward pedal (A) or the rearward pedal (B). The speed increases the more the pedal is pushed down (Fig. 29).
4. Release the pedals to brake.
5. Select the correct cutting height. [Refer to chapter 8.6.](#)
6. Engage the cutting deck. [Refer to chapter 8.5.](#)

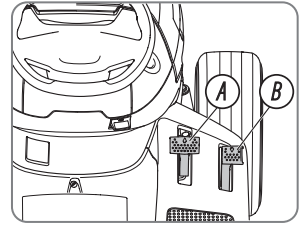

Fig. 29

**NOTE**

**The forward pedal and the rearward pedal go back to their neutral position when they are released.**

**8.8 TO USE THE REVERSE OPERATION SYSTEM (ROS)****NOTE**

**If you try to go rearward with the product when the cutting deck is engaged, the engine stops immediately. Engage the ROS to go rearward with the product when the cutting deck is engaged.**

**WARNING!**

**Before and while you operate the product rearward, look down and behind the product for the safety of others.**

1. Turn the ignition key counterclockwise to the ROS position to engage the ROS (Fig. 30A).
2. Slowly push down the rearward pedal to start movement.
3. Turn the ignition key clockwise to the engine "ON" (I) position to disengage the ROS (Fig. 30B).

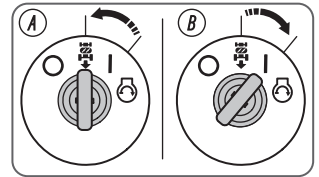

Fig. 30

**8.9 TO STOP THE ENGINE**

1. Disengage the cutting deck. [Refer to chapter 8.5.](#)
2. Turn the ignition key to the "OFF" (O) position (Fig. 31).
3. When the product stops, apply the parking brake. [Refer to chapter 8.4.](#)



Fig. 31

**8.10 TO GET A GOOD CUTTING RESULT**

- For best performance, do maintenance on the product regularly as given in the maintenance schedule. [Refer to chapter 9.](#)
- Do not cut a wet lawn. Wet grass can give a bad cutting result.
- Do not use tire chains when you operate the product with a cutting deck.
- Make sure that the cutting deck is level. [Refer to chapter 9.19.](#)
- If the grass is high, start with a high cutting height and decrease it gradually.
- Move the product forward at low speed if the grass is high and thick.
- Use full throttle when you cut the grass.
- Cut the grass in an irregular pattern.
- To get the best cutting result, cut the grass frequently.

**8.11 TO EMPTY THE GRASS CATCHER**

The product has an alarm that goes off if the grass catcher is full. To stop the alarm, disengage the cutting deck. [Refer to chapter 8.5.](#)

1. Move the product to a location where you can empty the grass catcher.
2. Make sure that the pedals are in the neutral position and engage the parking brake.
3. Pull up the grass catcher handle to the highest position (Fig. 32).

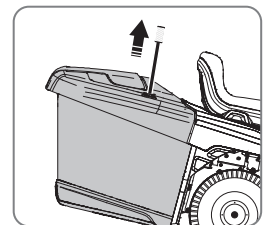
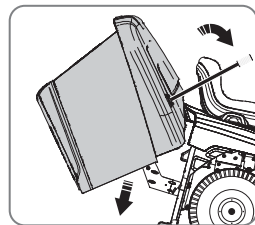

Fig. 32

- Pull the grass catcher handle forward to tilt the grass catcher and empty the grass (Fig. 33).
- Push the grass catcher handle rearward to lower the grass catcher. Make sure that the grass catcher is fully lowered and that the latches lock the lower part of the grass catcher in position.

Fig. 33



### MAINTENANCE

9

MAINTENANCE SCHEDULE		Before each use/weekly	After first 5 hours	Every 5 hours or daily	Every 50 h or annually	Every 100 hours
Engine	Examine the fuel hose for wear and damage. Replace the fuel hose if it is necessary.				<input type="radio"/>	
	Fuel filter check <sup>3)</sup> .					<input checked="" type="checkbox"/>
	Replace the fuel filter.				<input checked="" type="checkbox"/>	
	Air filter cleaning <sup>2)</sup> and check.	<input checked="" type="checkbox"/>		<input checked="" type="checkbox"/>		
	Replace the air filter <sup>2)</sup> .				<input checked="" type="checkbox"/>	
	Examine the muffler and the heat deflector.	<input checked="" type="checkbox"/>			<input checked="" type="checkbox"/>	
	Do a check of the engine oil level. Fill with engine oil if it is necessary.	<input checked="" type="checkbox"/>				
	Check oil level.			<input checked="" type="checkbox"/>		
	Replace the engine oil <sup>1)</sup> .		<input checked="" type="checkbox"/>		<input checked="" type="checkbox"/>	<input checked="" type="checkbox"/>
	Replace the engine oil filter.				<input checked="" type="checkbox"/>	
	Check spark plug.				<input checked="" type="checkbox"/>	
	Replace the spark plug.				<input checked="" type="checkbox"/>	<input checked="" type="checkbox"/>
Do a check of the engine speed. Adjust the engine speed if it is necessary.				<input type="radio"/>		
Transmission, controls and drive system	Examine the transmission cooling fan.	<input checked="" type="checkbox"/>			<input checked="" type="checkbox"/>	
	Remove the wheels and lubricate the axles.				<input type="radio"/>	
	Make sure that the product does not move when the pedals are in the neutral position.				<input checked="" type="checkbox"/>	
	Do a check of the forward and rearward drive at different speeds.				<input type="radio"/>	
	Do a check of the switch for the blade engagement control.				<input checked="" type="checkbox"/>	
	Do a check of the switch for the cutting height lever.				<input checked="" type="checkbox"/>	
	Do a check of the switches for the forward pedal and rearward pedal.				<input checked="" type="checkbox"/>	
	Do a check of the parking brake.	<input checked="" type="checkbox"/>				
	Do a check of the operator presence control (OPC).	<input checked="" type="checkbox"/>				

Cutting equipment	Clean the cutting deck, below the belt covers and below the cutting deck.				<input checked="" type="checkbox"/>	
	Do a check of the parallelism of the cutting deck. Adjust the cutting deck if it is necessary.				<input checked="" type="checkbox"/>	
	Examine the cutting deck belt for wear and damage.				<input type="checkbox"/>	
	Examine the blades for wear and damage. Sharpen or replace the blades if it is necessary.				<input checked="" type="checkbox"/>	
	Do a check of the blade brakes (if equipped).				<input type="checkbox"/>	
	Examine the grass catcher and the switches for the grass catcher (TC models only).				<input checked="" type="checkbox"/>	
General	Clean the battery and the terminals.				<input type="checkbox"/>	
	Do a check of the battery level. Charge the battery if it is necessary.				<input checked="" type="checkbox"/>	
	Examine all belts and pulleys for wear and damage. Replace worn or damaged parts.				<input type="checkbox"/>	
	Clean the engine and the transmission.	<input checked="" type="checkbox"/>			<input checked="" type="checkbox"/>	
	Examine all wires for damage.				<input type="checkbox"/>	
	Lubricate the product.				<input checked="" type="checkbox"/>	
	Make sure that all fasteners are tightened correctly.				<input type="checkbox"/>	
	Make sure that the tire pressure is correct in all tires.	<input checked="" type="checkbox"/>			<input checked="" type="checkbox"/>	

- The instructions are given in this operator's manual.  
 - The instructions are not given in this operator's manual. Let an approved service agent do the maintenance.

- <sup>1)</sup> Change oil every 25 hours if the engine is operating under heavy load or in hot weather.
- <sup>2)</sup> Clean air cleaner more frequently if the machine is operating in dusty areas.
- <sup>3)</sup> To be carried out by a specialized Centre.

### 9.1 LUBRICATION SCHEDULE

- A. General lubrication.** Lubricate the spindle grease connection and the gear teeth of the sector gear and the steering column (Fig. 34).  
**B. Engine lubrication.** [Refer to chapter 9.24.](#)

### 9.2 TO CLEAN THE PRODUCT



**WARNING!**



**Do not use a high-pressure washer or a steam cleaner. Water can go into bearings and electrical connections and cause corrosion which causes damage to the product.**

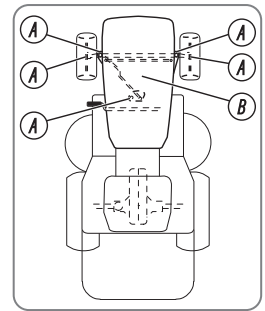

Fig. 34

Clean the product immediately after use.

- Do not clean hot surfaces such as the engine, muffler and exhaust system. Wait until the surfaces are cool, then remove the grass or dirt.
- Before you clean with water, clean with a brush. Remove grass cuttings and dirt on and around the transmission, the transmission air intake, and the engine.

- Clean the top of cutting deck, below the belt covers and below the cutting deck. *To clean the cutting deck, refer to chapter 9.4.*
- Use running water from a hose to clean the product. Do not use high pressure.
- Do not point the water at electrical components or bearings. Detergent usually increases the damage.
- When the product is clean, start the cutting deck for a short period to blow off remaining water.

### 9.3 TO CLEAN THE ENGINE AND THE MUFFLER

Keep the engine and muffler free from grass cuttings and dirt. Let the engine cool before it is cleaned. Grass residues entering the fuel or engine oil increase the risk of fire and engine overheating. Clean using a brush and water.

Use a jet of compressed air to remove any debris and dirt that could cause a fire from the silencer and its protective cover. Clean the plastic components with a sponge soaked in water and detergent.

### 9.4 TO CLEAN THE CUTTING DECK



**WARNING!**



**Do not use the product with a broken or missing deck washout port. There is a risk of thrown objects. Replace a broken or missing deck washout port immediately.**

2. Make sure that the cutting deck is disengaged. *Refer to chapter 8.5.*
3. Stop the engine. *Refer to chapter 8.9.*
4. Apply the parking brake. *Refer to chapter 8.4.*
5. Connect a garden hose (A) to the deck washout port (B) and start the water supply (Fig. 35).
6. Sit in the seat and start the engine. *Refer to chapter 8.2.*



**WARNING!**



**Examine the area again to make sure that the area is clear before you start the engine.**

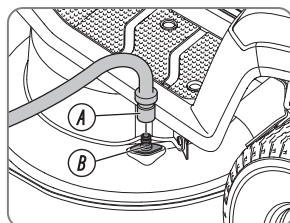

Fig. 35

7. Engage the cutting deck and let it operate at full throttle until the cutting deck is clean. *Refer to chapter 8.5.*
8. Disengage the cutting deck and stop the engine. *Refer to chapter 8.5 and 8.9.*
9. Stop the water supply and disconnect the garden hose from the deck washout port.
10. Move the product to a dry area.
11. Sit in the seat and start the engine. *Refer to chapter 8.2.*
12. Engage the cutting deck and let it operate until the cutting deck is dry.

### 9.5 TO CLEAN THE AIR INTAKE OF THE ENGINE



**ATTENTION – DANGER!**



**Stop the engine. The air intake has rotating parts which can cause injury to your fingers.**

Open the engine cover. Make sure that the air intake on the engine (Fig. 36). Remove grass and dirt with a brush.

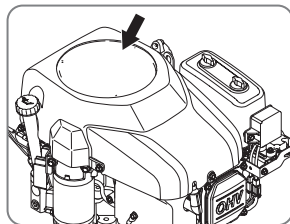

Fig. 36

### 9.6 TO CLEAN THE COOLING FAN ON THE TRANSMISSION



**ATTENTION – DANGER!**



**Stop the engine. The cooling fan rotates and can cause injury to your fingers.**

1. Remove the center chute. *Refer to chapter 9.17.*
2. Clean the cooling fan on the transmission with compressed air (Fig. 37).

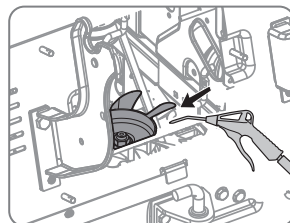

Fig. 37

## 9.7 TO REMOVE AND INSTALL THE ENGINE COVER

1. Open the engine cover.
2. Disconnect the headlight wire connector (Fig. 38, B) (there are two places; press the trapezoidal part on the surface of the connector and apply a little force to disconnect it);
3. Remove the retaining pins on both sides of the lawn mower, first pull out the R-type pin, then remove the cotter pin (Fig. 38, A);
4. Install the engine cover in the reverse order.

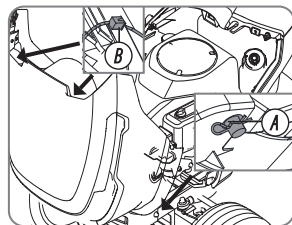

Fig. 38

## 9.8 TO REPLACE THE HEADLIGHT ASSEMBLY

1. Open the hood.
2. Disconnect the wiring connectors (Fig. 38, B) for the left and right headlights.
3. Remove the headlight that needs to be replaced and install the new one.
4. Reconnect the headlight wiring in reverse order and close the hood.

## 9.9 TO DO A CHECK OF THE PARKING BRAKE

1. Park the product on a hard surface that slopes. when you do a check of the parking brake.



NOTE



**Do not park the product on a grass slope when you do a check of the parking brake.**

2. Apply the parking brake. *Refer to chapter 8.4.*
3. If the product starts to move, let an approved service agent adjust the parking brake.
4. Push the parking brake pedal again to release the parking brake.

## 9.10 TO REPLACE THE FUEL FILTER



NOTE



**The illustration shows one type of fuel filter. The fuel filter on your product can be different, but the procedure is the same.**

1. Open the engine cover to get access to the fuel filter.
2. Compress the fuel valve to prevent leakage.
3. Move the hose clips away from the fuel filter with a pair of flat pliers.
4. Pull the fuel filter from the hose ends (Fig. 39). A small quantity of fuel can leak.
5. Push the new fuel filter into the hose ends. Apply liquid detergent to the ends of the fuel filter to make the connection easier.
6. Push the hose clips against the fuel filter (Fig. 40).

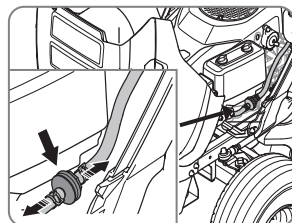

Fig. 39

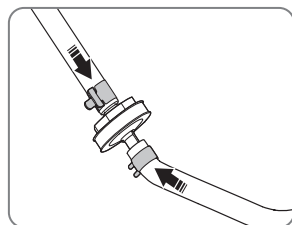

Fig. 40

## 9.11 TO CLEAN AND REPLACE THE AIR FILTER

1. Open the engine cover.
2. Loosen the knobs that hold the air filter cover and remove the cover (Fig. 41).
3. Remove the air filter cartridge from the filter housing (Fig. 42).
4. To clean the foam air filter, do the steps that follow.
  - a) Remove the foam air filter from the air filter cartridge.
  - b) Clean the foam air filter with a weak detergent.
  - c) Let the foam air filter become dry.
  - d) Install the foam air filter around the air filter cartridge.

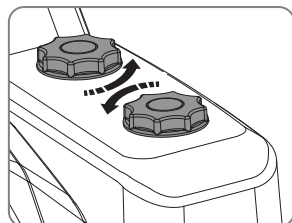

Fig. 41

5. To clean the paper air filter, do the steps that follow.
  - a) Hit the paper air filter against a hard surface.
  - b) Blow with compressed air from the inner side of the paper air filter.

**WARNING!**

**If the paper air filter does not become clean, the paper air filter must be replaced.**

6. Install in the opposite sequence.



### 9.12 TO EXAMINE AND REPLACE A SPARK PLUG

1. Open the engine cover.
2. Remove the spark plug cap and clean around the spark plug.
3. Remove the spark plug with a spark plug wrench.
4. Examine the spark plug. Replace it if the electrodes are burned or if the insulation has cracks or damages. If the spark plug is not damaged, clean it with a steel brush.
5. Measure the electrode gap and make sure that it is correct (Fig. 43). *Refer to chapter 5.*
6. Bend the side electrode to adjust the electrode gap.
7. Put the spark plug back in and turn it by hand until it touches the spark plug seat.
8. Tighten the spark plug with the spark plug wrench until the washer is compressed.
9. Tighten a used spark plug 1/8 of a turn more, and a new spark plug 1/4 turn more.

**WARNING!**

**Spark plugs that are not tightened correctly can cause damage to the engine.**

10. Attach the spark plug cap.

**WARNING!**

**Do not try to start the engine if the spark plug or ignition cable is removed.**

### 9.13 TO REPLACE THE MAIN FUSE

A 20A fuse is used to protect the circuit (Fig. 44). If it is damaged, the machine will have startup issues. Important reminder: broken fuses must always be replaced with fuses of the same type and rated current, and must never be replaced with fuses of other rated currents. If you don't understand why the fuse is damaged, please contact your dealer



**WARNING!**

**If the machine is not used for a long time, the positive and negative wires of the battery must be removed; It is recommended not to leave the battery for more than 3 months as it may affect the normal startup of the machine.**

Fig. 42

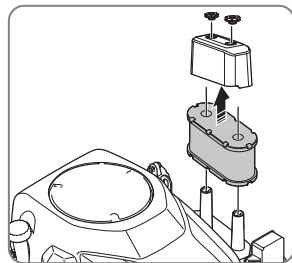

Fig. 43

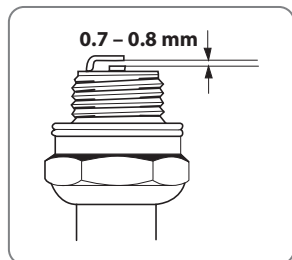
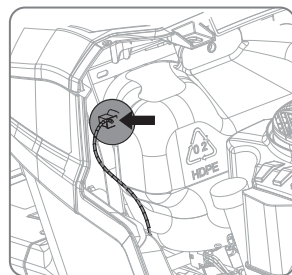

Fig. 44



## 9.14 TO REPLACE THE BATTERY (Fig. 45)



**ATTENTION – DANGER!**

**Risk of electrical shock and burn injuries. Do not use metal wristbands or other metal accessories. Metal items that touch the battery terminals can cause burn injuries, electrical shock, and short circuit of the battery.**

1. Remove the strap and the battery cover.



**NOTE**



**The battery is located behind the seat**

2. Remove the terminal cover on the black battery cable.
3. Remove the screw, the nut, and the black battery cable from the negative (-) terminal on the battery.
4. Remove the terminal cover on the red battery cable.
5. Remove the screw, the nut, and the red battery cable from the positive (+) terminal on the battery.
6. Carefully remove the battery from the product.
7. Put a new battery in position.
8. Attach the red battery cable to the positive (+) terminal on the battery and install the nut and the screw.
9. Install the terminal cover on the red battery cable.
10. Attach the black cable to the negative (-) terminal on the battery and install the nut, the screw and the terminal cover.
11. Install the battery cover and the attach the strap.

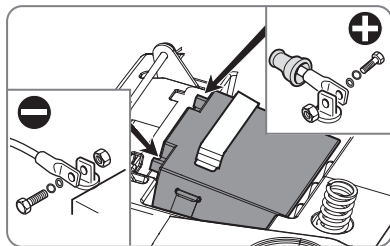

Fig. 45

## 9.15 TIRE PRESSURE

Make sure that the tire pressure is correct in all 4 tires. [Refer to chapter 5.](#)

## 9.16 CUTTING DECK

**To remove and install the cutting deck.**

1. Disengage the cutting deck and stop the engine.
2. Put the cutting deck in the lowest position.
3. Remove the bolts on the skirt edge (Fig. 46), two on each side, for a total of four bolts, and take out the skirt edges on both sides of the machine.
4. Disassemble the tension spring of the cutterhead belt (Fig. 47), and separate one end of the spring from the hook on the cutterhead.
5. Remove the bolts of the belt cover (Fig. 48), two on each side, for a total of four bolts, and take out the belt covers on both sides of the machine.
6. Remove the drive belt from the engine pulley.
7. Remove the two R pins (forward and reverse gear side) and the washers and pins (Fig. 49), totaling 2 R pins, 2 washers, and 2 pins.
8. Remove the two R-pins, as well as the gasket and pin, from the brake gear side (Fig. 49), totaling 2 R pins, 2 gaskets, and 2 pins.

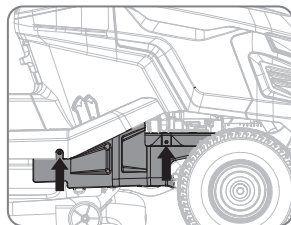

Fig. 46

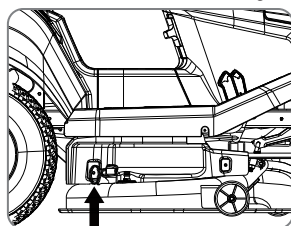

Fig. 47



**ATTENTION – DANGER!**

**Removing the pin may cause the cutterhead to fall rapidly. Please place a support under the cutterhead before removing the pin; Do not place your hands or feet under the blade before unplugging the pin.**

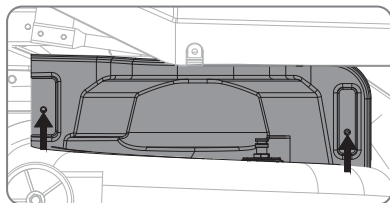
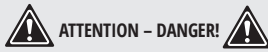

Fig. 48



**The cutting deck is heavy. Use a crowbar or equivalent below the cutting deck to hold the weight of the cutting deck when you disconnect the 2 rear links.**

- a) Remove the clip (1), the washer (2) and the pin (3) from the left rear link.
- b) Disconnect the cutting deck from the left rear link.
- c) Pull and hold the cutting height lever in the lowest position with one hand. Remove the clip.

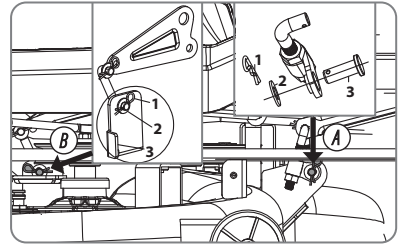
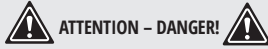

Fig. 49



**Do not release the cutting height lever. The mechanism for the cutting height adjustment is spring-loaded. The force from the spring can cause crush injury if you do not pull and hold the cutting height lever.**

- d) Disconnect the cutting deck from the right rear link.
- e) Carefully release the cutting height lever.

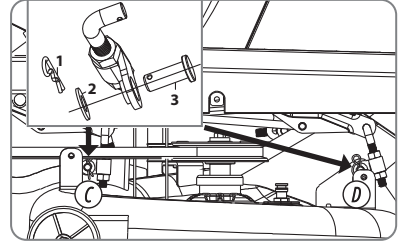

Fig. 51



**The mechanism for the cutting height adjustment is spring-loaded. The force from the spring can cause crush injury. Keep body parts away.**

- 9. Fig 50 illustrates the ACD. The three assembly structures are shown in the diagram. 1 is the R pin, 2 is the gasket, and 3 is the pin. Remove the 1, 2 from the ACD and then pull out 3 to remove the cutterhead .
- 10. After opening the four pins of ABCD mentioned above, take out the cutterhead from the side (Fig. 51).
- 11. Install the cutting deck in the opposite sequence.

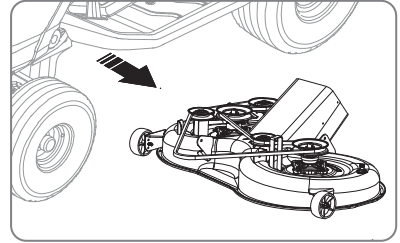

Fig. 52



**Make sure that the drive belt is installed correctly and does not get compressed when you install the cutting deck.**

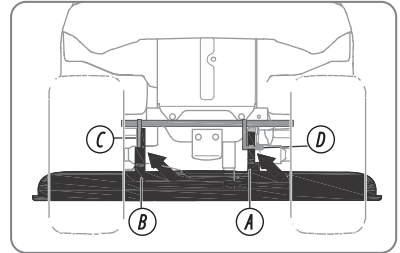
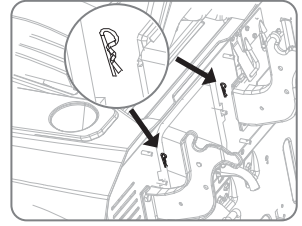

Fig. 52. When installing the cutterhead, please ensure that the bracket is in the connected position, and the mounting plate (A) on the right cutterhead should be on the right side of the assembly plate (D) on the entire machine; The mounting plate (B) on the left cutterhead should also be on the right side of the assembly plate (C) on the entire machine.

### 9.17 TO REMOVE AND INSTALL THE CENTER CHUTE

Fig. 53

1. Disengage the cutting deck and stop the product.
2. Set the power switch in the off (O) position and remove the power switch key.
3. Remove the grass catcher.
4. Pull out the R-shaped pin (Fig. 53).
5. Pull out the center chute.
6. Install the center chute in the opposite sequence.



### 9.18 TO ADJUST THE PARALLELISM OF THE CUTTING DECK

Fig. 54

#### To do a side-to-side adjustment of the cutting deck

If the cutting height is different between the right and left side, the cutting height can be adjusted.

1. Make sure that the tire pressure is correct in all 4 tires. [Refer to chapter 9.15.](#)
2. Park the product on a level surface.
3. Put the cutting deck in the highest position.
4. Measure the distance (X) from the bottom edge of the cutting deck to the ground on the left and right side. The distance must be the same on the 2 sides (Fig. 54).

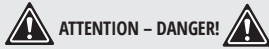
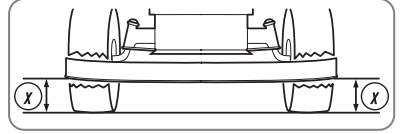

**ATTENTION – DANGER!**



**The blades on the cutting deck are sharp and can cause injury. Use protective gloves.**

5. Loosen the outer anti loosening nut at point B (Fig. 55) and unscrew it to a certain distance from the inner nut. By rotating the inner nut to control the overall lifting and lowering of the cutterhead, the ground clearance behind the cutterhead (forward and reverse gear sides) is controlled at 28×32mm. At this point, do not tighten the inner nut. Finally, tighten the outer anti loosening nut tightly against the inner nut and tighten it.
6. The adjustment method for A, C, and D is the same (Fig. 56).

Fig. 55

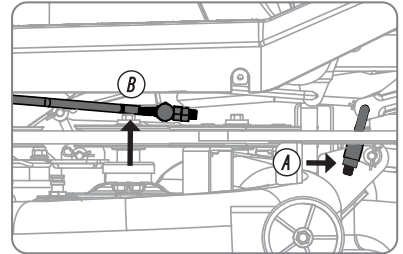

If it is necessary to raise the cutterhead, loosen the upper anti loosening nut and screw it to the appropriate height. Then, screw the other nut below upwards until it fits the upper part and locks it.

If it is necessary to adjust the cutterhead downwards, loosen the lower anti loosening nut and screw it to a suitable low position, then screw the other upper nut downwards until it fits the lower part and locks it. Attention: It is recommended to adjust the heights of the cutter head ABCD in the order of B → C → D → A.

Fig. 56

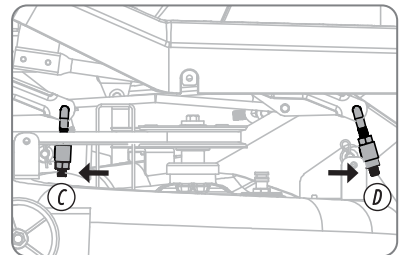

Ultimately, it should be ensured that the ground clearance at the edge of the rear single disc is 28×32mm, and the optimal ground clearance at the edge of the front cutter disc is 20-23mm. Please note that the ground clearance between the left and right cutterheads should be consistent.

#### To do a front-to-rear adjustment of the cutting deck

The cutting deck must be level side to side before you do front to rear adjustment. [Refer to chapter 9.18](#) "To do a side-to-side adjustment of the cutting deck"

1. Make sure that the tire pressure is correct in all 4 tires. [Refer to chapter 9.16.](#)

2. Park the product on a level surface.
3. Put the cutting deck in the highest position.
4. Measure the distance from the bottom edge of the cutting deck to the ground at the rear (A) and at the front (B), Fig 57. The distance at the front must be 5–10 mm lower than at the rear.

Fig. 57

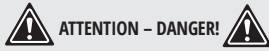
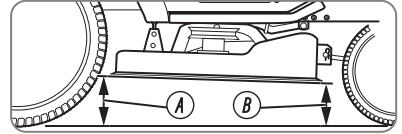

**ATTENTION – DANGER!**



The blades on the cutting deck are sharp and can cause injury. Use protective gloves.

### 9.19 TO EXAMINE THE BLADES



**WARNING!**



Damaged or incorrectly balanced blades can cause damage to the product. Replace damaged blades. Let an approved service agent help you sharpen and balance blunt blades.

1. Remove the cutting deck. [Refer to chapter 9.16.](#)
2. Look at the blades to see if they are damaged and if it is necessary to sharpen them (Fig. 58).

Fig. 58

### 9.20 TO REPLACE THE BLADES

1. Lock the blades with a wooden block (Fig. 59).



**IMPORTANT!**



Both blades are twisted counterclockwise.

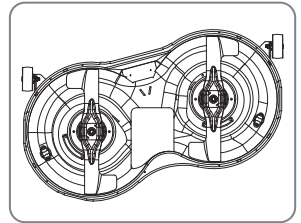

Fig. 59

2. Remove the nut (A) and blade (B).
3. Place the blade with the arrow facing the ground (Fig. 60). The blade arrow on the forward gear side of the lawn mower rotates counter clockwise, and the blade arrow on the brake gear side of the side lawn mower rotates clockwise.

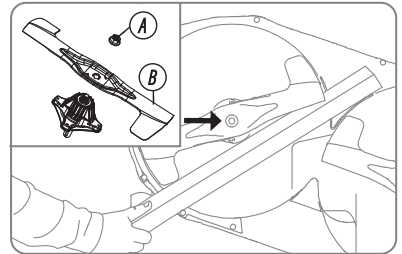

Fig. 60



**IMPORTANT!**



The blades have different direction of rotation. The right blade must be installed on the right side and the left blade must be installed on the left side.



**ATTENTION – DANGER!**



Incorrect blade type can cause objects to eject from the cutting deck and cause serious injury. Use only the blades given in.

4. Make sure that the bent ends on the blades point in the direction of the cutting deck.
5. Torque the bolts to 100 Nm.

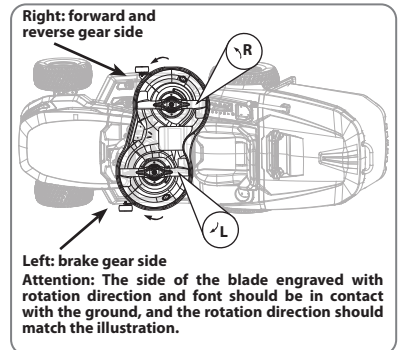

**9.21 TO REPLACE THE CUTTING DECK BELT**

1. Remove the cutting deck. [Refer to chapter 9.16.](#)
2. Remove the dirt and grass around the bearing housings, blade pulleys and from the top surface of the cutting deck.
3. When disassembling the belt, the tension spring at point G should be loosened first, and then the belt should be disassembled in the order of A – B – C – F → E > D to remove and replace it (Fig. 61).
4. Install a new cutting deck belt in the opposite sequence. Make sure that the cutting deck belt is in the correct position in all belt pulleys (Fig. 62).

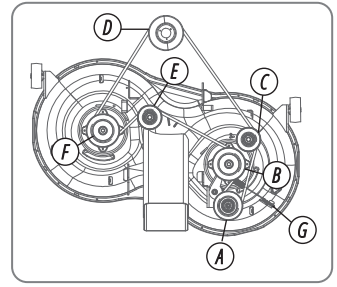
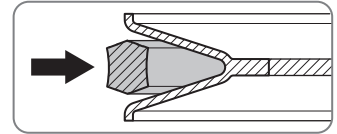

Fig. 62

**WARNING!**

**Make sure that the cutting deck belt is not twisted.**

**9.22 TO ADJUST THE ANTI-SCALP WHEELS**

The anti-scalp wheels keep the cutting deck in the correct position on the ground and prevent lawn scalping in most terrain conditions. The anti-scalp wheels are adjusted correctly when they are slightly off the ground when the cutting deck is at the necessary cutting height.

1. Park the product on a level surface and stop the engine.
2. Put the cutting deck in the necessary cutting height. [Refer to chapter 8.6.](#)
3. Remove the nut (A), the bolt (B), and the anti-scalp wheel (C), Fig. 63).
4. Install the anti-scalp wheel, the bushing, the bolt, the washer, and the nut in 1 of the 3 holes.
5. Adjust all anti-scalp wheels in the same procedure.

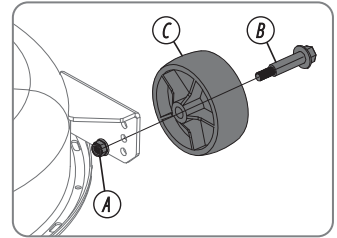

Fig. 63

**9.23 TO DO A CHECK OF THE ENGINE OIL LEVEL**

1. Park the product on level ground and stop the engine.
2. Open the engine cover.
3. Loosen the dipstick and pull it out (Fig. 64).
4. Clean the oil from the dipstick.
5. Put the dipstick back in and tighten it.
6. Loosen and pull the dipstick out and read the oil level. To replace the cutting deck belt
7. The oil level must be between the marks on the dipstick (Fig. 65). If the level is near the ADD mark, fill oil to the FULL mark.
8. Fill the oil through the hole that the dipstick sits in. Fill the oil slowly.
9. Tighten the dipstick correctly before you start the engine. Start and idle the engine for approximately 30 seconds. Stop the engine. Wait 30 seconds and do a check of the oil level again.

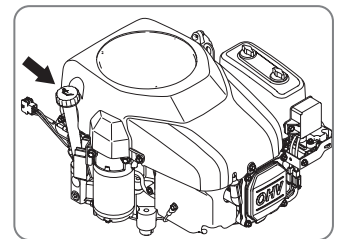

Fig. 64

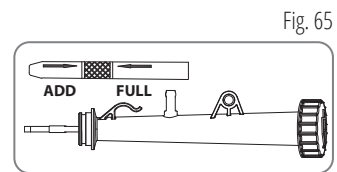

Fig. 65

**9.24 TO REPLACE THE ENGINE OIL**

If the engine is cold, start the engine and let it operate for 1–2 minutes before you drain the engine oil. This makes the engine oil warm and faster to drain.



ATTENTION – DANGER!

Do not operate the engine for more than 1–2 minutes before you drain the engine oil. The engine oil becomes very hot and can cause burn injuries. Let the engine become cool before you drain the engine oil.



WARNING!



If you spill engine oil on your body, clean with soap and water.

1. Remove the oil drain hose (A) from the holder (B) and put the oil drain hose through the gap (C), Fig. 66.
2. Put a container below the oil drain plug.
3. Remove the dipstick.
4. Remove the end cap on the oil drain valve on the oil drain hose and let the engine oil drain into the container (Fig. 67).
5. When all oil is drained, install the end cap on the oil drain valve.
6. If the engine has an oil filter, replace the oil filter.  
*Refer to chapter 9.25.*
7. Fill the oil slowly through the hole for the dipstick. Use an oil with viscosity that agrees with the temperature ranges. *Refer to chapter 5.*

Fig. 66

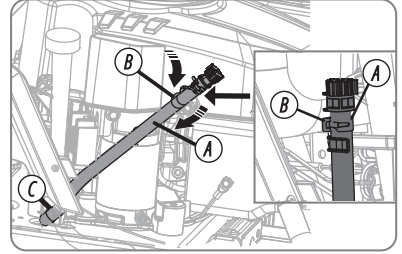
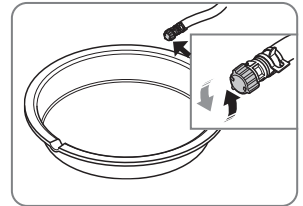
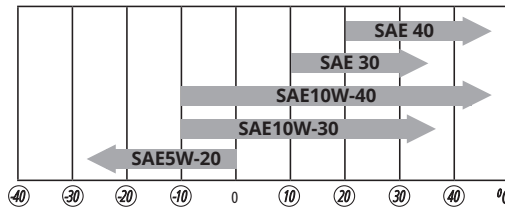

Fig. 67



WARNING!



Do not mix different types of oil.

8. Install the dipstick.
9. Discard the used engine oil.

### 9.25 TO REPLACE THE OIL FILTER



WARNING!



Use protective gloves. If you spill engine oil on your body, clean with soap and water.

1. Drain the engine oil. *Refer to chapter 9.24.*
2. Turn the oil filter counterclockwise to remove it.
3. Lightly lubricate the rubber seal on the new oil filter with new engine oil.
4. Turn the oil filter clockwise by hand until the rubber seal is in position, then tighten a half turn more.
5. Fill the engine with new engine oil. *Refer to chapter 9.24.*
6. Start the engine and let it operate at idle speed for 3 minutes.
7. Stop the engine and make sure that there is no oil leakage from the oil filter.
8. Fill with engine oil to make up for the oil held in the new oil filter.

### 10.1 TRANSPORTATION

- The product is heavy and can cause crush injuries. Be careful when you load it onto or off a vehicle or trailer.
- Use an approved trailer for transportation of the product.
- Make sure that you have knowledge of local road traffic regulations before transportation of the product in a trailer or on roads.
- To make it easier to load the product onto a trailer, put the cutting deck in the highest position.

### 10.2 TO SAFELY ATTACH THE PRODUCT FOR TRANSPORTATION

**WARNING!****Before you attach the product, you must read and understand the safety chapter. Refer to chapter 1.****WARNING!****The parking brake is not sufficient to lock the product during transportation. Attach the product tightly to the load area.**

**Equipment:** 2 approved straps and 4 chocks.

1. Park the product in the center of the load area (see Annex, fig. 68).

**IMPORTANT!****For transportation in transport vehicles with a cover, let the product become cool before you put it below the cover.**

2. Make sure that the center of gravity of the product is above the wheel axle of the transport vehicle. If a trailer is used for transportation, make sure that the vertical force on the tow bar is correct (see Annex, fig. 69)
3. Apply the parking brake.
4. Remove all loose objects.
5. Attach the first strap to the tow bar (see Annex, fig. 71).
6. Tighten the strap rearward to attach the product to the load area.
7. Put the second strap around the front axle (see Annex, fig. 70).
8. Attach the strap to the load area.
9. Tighten the strap in the direction of the front of the load area to attach the product to the load area.
10. Put the chocks in front of and behind the rear wheels (see Annex, fig. 72).

### 10.3 STORAGE

Prepare the product for storage at the end of the season, and before more than 30 days of storage. If you keep fuel in the fuel tank for 30 days or more, tacky particles can cause blockage in the carburetor. This has a negative effect on the engine function.

To prevent tacky particles during storage, add a stabilizer. If alkylate gasoline is used, stabilizer is not necessary. If you use standard gasoline, do not change to alkylate gasoline. This can cause sensitive rubber parts to become hard. Add stabilizer to the fuel in the tank or in the container used for storage. Always use the mixing ratios given by the manufacturer. Run the engine for a minimum of 10 minutes after you add the stabilizer until it flows into the carburetor.

**ATTENTION – DANGER!****Do not keep the product with fuel in the tank in an indoor location or in locations with bad airflow. Risk of fire if fuel fumes come near open flames, sparks, or pilot lights in for example boilers, hot water tanks and clothes dryers.**



ATTENTION – DANGER!



Remove grass, leaves and other flammable materials from the product to decrease the risk of fire. Let the product become cool before you put it in storage.

- Clean the product. [Refer to chapter 9.2.](#) Repair paint damages to prevent corrosion.
- Examine the product for worn or damaged parts and tighten loose screws and nuts.
- Remove the battery. Clean it, charge it, and keep it cool during storage.
- Change the engine oil, and discard the waste oil.
- Empty the fuel tank. Start the engine and let it operate until there is no remaining fuel in the carburetor.



IMPORTANT!



Do not empty the fuel tank and carburetor if a stabilizer has been added.

- Close the fuel shut-off valve.
- Remove the spark plugs and put approximately a tablespoon of engine oil into each cylinder. Manually turn the engine shaft to apply the oil and put the plugs back on.
- Lubricate all grease nipples, joints and axles.
- Keep the product in a clean and dry area and put a cover on it for more protection.
- A cover for protection of your product during storage or transportation is available at your dealer.

#### 10.4 DISPOSAL

- Chemicals can be dangerous and must not be discarded on the ground. Always discard used chemicals at a service center or an applicable disposal location.
- When the product is worn out, send it to the dealer or to an applicable recycling location.
- Oil, oil filters, fuel and the battery can have negative effects on the environment. Obey the local recycling requirements and applicable regulations.
- Do not discard the battery as domestic waste.
- Send the battery to service agent or discard it at a disposal location for used batteries.

## TROUBLESHOOTING

11

Problem	Possible cause	Remedy
<b>The starter motor does not crank the engine.</b>	The parking brake is not applied.	Apply the parking brake. <a href="#">Refer to chapter 8.4.</a>
	The cutting deck is engaged.	Disengage the cutting deck. <a href="#">Refer to chapter 8.5.</a>
	The main fuse is blown.	Replace the main fuse. <a href="#">Refer to chapter 9.13.</a>
	The ignition lock is broken.	Speak to your servicing dealer.
	The connection between the cable and the battery is bad.	Make sure that the battery is connected correctly. <a href="#">Refer to chapter 6.13.</a>
	The battery is too weak.	Charge the battery.
	The starter motor is damaged.	Speak to your servicing dealer.
<b>The engine does not start when the starter motor cranks the engine.</b>	There is no fuel in the fuel tank.	Fill the fuel tank with fuel. <a href="#">Refer to chapter 7.2.</a>
	Spark plug disconnected.	Check that the spark plug cap fits well over the plug terminals.
	The spark plug is wet or the spark plug electrodes are dirty or placed inadequately.	Examine the spark plug.
	The spark plug is damaged.	Examine the spark plugs. Replace the spark plugs if it is necessary. <a href="#">Refer to chapter 9.12.</a>
	The ignition cable is damaged.	Speak to your servicing dealer.

<b>The engine does not start when the starter motor cranks the engine.</b>	Replace the air filter.	Speak to your servicing dealer.
	The fuel filter is clogged.	Replace the fuel filter. <a href="#">Refer to chapter 9.10.</a>
	Incorrect oil for the season.	Replace with proper oil.
	Fuel evaporation in the carburetor (vapor lock) due to high temperatures	Wait for a few minutes then start again.
	Fault in carburation.	Speak to your servicing dealer.
	Hard starting.	Speak to your servicing dealer.
<b>The engine does not run smoothly.</b>	The spark plug is damaged.	Examine the spark plugs. Replace the spark plugs if it is necessary. <a href="#">Refer to chapter 9.12.</a>
	The carburetor is incorrectly set.	Speak to your servicing dealer.
	The air filter is clogged.	Clean or replace the air filter. <a href="#">Refer to chapter 9.11.</a>
	The fuel tank vent is blocked.	Speak to your servicing dealer.
	There is dirt in the carburetor or fuel line.	Speak to your servicing dealer.
	The fuel filter is clogged.	Replace the fuel filter. <a href="#">Refer to chapter 9.10.</a>
<b>The engine has no power.</b>	The air filter is clogged.	Clean or replace the air filter. <a href="#">Refer to chapter 9.11.</a>
	The spark plug is damaged.	Examine the spark plugs. <a href="#">Refer to chapter 9.23.</a>
	There is dirt in the carburetor or fuel line.	Speak to your servicing dealer.
	The throttle cable is incorrectly adjusted.	Speak to your servicing dealer.
<b>The engine stops when you try to mow in reverse.</b>	The reverse operation system (ROS) is not engaged.	Engage the reverse operation system (ROS). <a href="#">Refer to chapter 8.8.</a>
<b>The transmission does not have sufficient power.</b>	The transmission air intake or the cooling fins are blocked.	Speak to your servicing dealer.
	The fan on the transmission is damaged.	Speak to your servicing dealer.
	There is no oil in the transmission or the oil level is too low.	Speak to your servicing dealer.
	The drive system is disengaged.	Engage the drive system. <a href="#">Refer to chapter 8.3.</a>
	Governor out of phase with respect to the accelerator.	Adjust the cable.
<b>The battery does not charge.</b>	The battery is damaged.	Replace the battery. <a href="#">Refer to chapter 9.14.</a>
	The connection at the battery terminals is bad.	Make sure that the battery is connected correctly. <a href="#">Refer to chapter 6.13.</a>
<b>There is vibration in the product.</b>	The blades are loose.	Tighten the blades.
	The blades are incorrectly installed.	Make sure that the blades are installed correctly. <a href="#">Refer to chapter 9.19.</a>
	The blades are not balanced.	Examine the blades for wear and damage. <a href="#">Refer to chapter 9.19.</a>
	The engine is loose.	Speak to your servicing dealer.
	The belt pulleys are skew or loose.	Speak to your servicing dealer.

<b>The cutting result is unsatisfactory.</b>	The blades are blunt.	Examine the blades for wear and damage. <a href="#">Refer to chapter 9.19.</a>
	The grass is long or wet.	<a href="#">Refer to chapter 8.10.</a>
	The cutting deck is not parallel.	Adjust the parallelism of the cutting deck. <a href="#">Refer to chapter 9.18.</a>
	There is grass blockage in the cutting deck.	Clean the cutting deck. <a href="#">Refer to chapter 9.4.</a>
	The air holes in the cutting deck are clogged.	Clean the cutting deck. <a href="#">Refer to chapter 9.4.</a>
	There is dirt around the blade pulleys.	Clean the cutting deck. <a href="#">Refer to chapter 9.4.</a>
	The tire pressure is different on the right and left sides.	Make sure that the tire pressure is correct in all 4 tires. <a href="#">Refer to chapter 9.15.</a>
	The product is operated at a too high speed.	<a href="#">Refer to "Specification", chapter 5.</a>
	The engine speed is too low.	<a href="#">Refer to "Specification", chapter 5.</a>
	The cutting deck belt slips.	Speak to your servicing dealer.
The cutting deck belt is worn or damaged.	Replace the cutting deck belt. <a href="#">Refer to chapter 9.21.</a>	
<b>The blades of the cutting deck does not start to rotate when the cutting deck is engaged.</b>	There is no grass catcher, or other accessory, installed to the grass discharge (if applicable).	Install the grass catcher, or other accessory, to the grass discharge (if applicable).

## OPTIONAL ACCESSORY ASSEMBLY AND FUNCTIONS

12

### 12.1 REAR INSTALLATION (see Assembly instructions, Fig. 20)

1. Insert the four holes on the rear seat (C) into the cylinder (B) (four in total) as shown in the diagram;
2. Insert the R-shaped pin (A) into the holes of the cylinder (four in total). Attention: This part is an optional accessory and may not be included in your machine. When using this part, do not install a grass catcher.
3. After installing this component, the grass from the lawn mower will be discharged from this component.

### 12.2 INSTALLATION OF PLUG (see Assembly instructions, Fig. 21)

1. Place the board (A) on the plug into the rear air duct (B) of the lawn mower. Note that when placing it, the board (A) should be placed at the angle shown in the diagram, and at the same time, ensure that the board (A) blocks the internal space of the air duct (B) without gaps;
2. Hang the hooks (C) on the rod (two in total) into the holes on the grass box hanging ears (D).



**WARNING!**



**This part is an optional accessory and may not be included in your machine. When using this part, a grass catcher must be installed.**

3. After installing this component, the lawn mower will break the grass and the broken grass will be discharged from the inside of the cutterhead.

## WARRANTY SERVICE TERMS

13

The international manufacturer warranty is 1 year. The warranty period starts from the date of purchase. In cases when the warranty period is longer than 1 year according to local legislation please contact your local dealer. The Seller who sells the product is responsible for granting the warranty. Please contact the Seller for the warranty service. Within the warranty period, if the product fails because of defects in the production process, it will be exchanged for the same product or repaired.

All faults caused by the manufacturer during the warranty period will be eliminated free of charge. Warranty repair is carried out only if you have a fully completed warranty card, the Buyer's signature of acceptance of the warranty terms, as well as a document supporting the purchase (cash receipt, sales slip or invoice). In the absence of this information and documents, as well as in the event of errors or corrections not authenticated by the seller's seal or illegible inscriptions in the warranty card or tear-off coupon, no warranty repair is carried out, no objections to quality are accepted and the warranty card is withdrawn by the service center as invalid. The device must be submitted for repair clean and complete.



Fig. 68

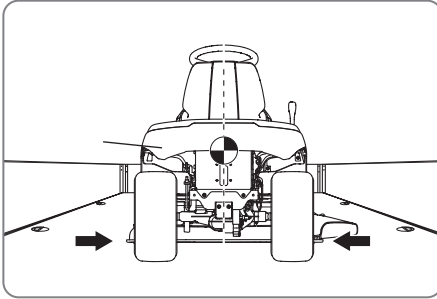

Fig. 69

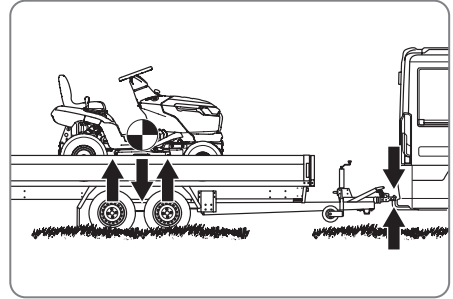

Fig. 70

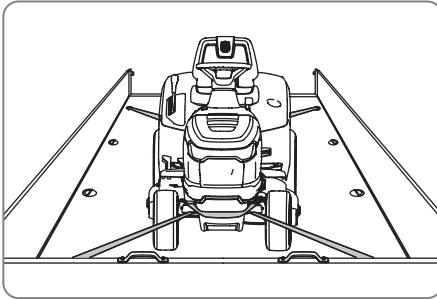

Fig. 71

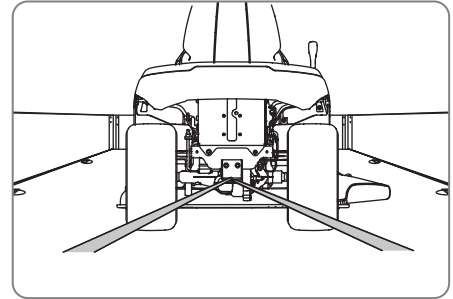
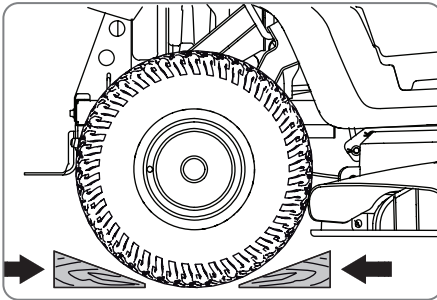

Fig. 72





# EC Declaration of Conformity

Nr. 263

The following products have been tested by us with the listed standards and found in compliance with the European Community Machinery Directive 2006/42/EC, Electromagnetic compatibility Directive (EMC) 2014/30/EC, Noise Directive 2000/14/EC.

Manufacturer: DIMAX INTERNATIONAL GmbH  
Address: Flinger Broich 203, 40235 Duesseldorf, Germany  
Product: Gasoline tractor lawn mower "Könner & Söhnen"  
Type / Model: KS 98TMG-H

The statement is based on a single evaluation of above mentioned products. It does not imply an assessment of the whole production and does not permit the use of the test lab. logo. The manufacturer should ensure that all product in series production are in conformity with the product sample detailed in this report. The applicant should hold the whole technical report at disposal of the competent all the right.

Applied EC Directives: 2006/42/EC Machinery Directive  
2014/30/EC Electromagnetic compatibility Directive  
2000/14/EC Noise Directive

Applied Standards: EN ISO 14982:2009  
EN ISO 5395-1:2013/A1:2018  
EN ISO 5395-3:2013/A2:2018

Gasoline engine corresponds to European Emission Standard Euro V (Stage V). This is confirmed by EU TYPE-APPROVAL CERTIFICATE issued by department of transport of Madrid, Spain.  
Technical service responsible for carrying out the test - IDIADA.  
Date of issue 04/11/2024 | 22/11/2024

## 2000/14/EC\_2005/88/EC Annex VI

For model KS 98TMG-H Noise guaranteed Lwa = 99 dB (A).



**Issued Date:**  
**Place of issue:**  
**Director:**

2025-12-16  
Duesseldorf  
Fomin P.

*P. Fomin*

**DIMAX**

International GmbH  
Flinger Broich 203 40235 Düsseldorf  
USt-ID DE296177274  
koenner-soehnen.com

We DIMAX INTERNATIONAL GmbH hereby declare that specified above conforms covering European Parliament and Council Directives, 2006/42/EC of 17 May 2006 Machinery Directive, Electromagnetic compatibility Directive (EMC) 2014/30/EC of 26 February 2014, Noise Directive 2000/14/EC of 8 May 2000. The CE mark above can be used under the responsibility of manufacturer. After completion of an EC declaration of Conformity and compliance with all relevant EC directives.

## CONTACTS

**Deutschland:**

Hergestellt unter Lizenz und Kontrolle der DIMAX International GmbH.

Importeur und Vertreter in Deutschland:  
DIMAX International GmbH, Flinger Broich 203,  
40235 Düsseldorf, Deutschland. Produziert in VRC.  
amazon@dimaxgroup.com  
[www.konner-sohnen.com](http://www.konner-sohnen.com)

---

**European Union:**

Manufactured under license and control of DIMAX International GmbH, Flinger Broich 203, 40235 Duesseldorf, Germany.

Importer and representative in Netherlands DIMAX International Poland Ltd, Południowa 8 st,  
05-830 Stara Wieś, Poland. Assembled in PRC.  
amazon@dimaxgroup.com  
[www.konner-sohnen.com](http://www.konner-sohnen.com)

---

**The United Kingdom:**

Innovation Trade Ltd., 5th Floor, 167-169 Great Portland Street, London, W1W 5PF, sales.uk@dimaxgroup.com

**Technical support**

support.uk@dimaxgroup.de  
[www.konner-sohnen.uk](http://www.konner-sohnen.uk)

---

**France:**

Fabriqu e sous licence et contr ole de DIMAX International GmbH, Flinger Broich 203, 40235 D usseldorf, Allemagne.

Importateur et repr esentant en France et en Belgique  
DIMAX International Poland Ltd, Południowa 8 st,  
05-830 Stara Wieś, Pologne. Assembl e en RPC.  
amazon@dimaxgroup.com  
[www.konner-sohnen.fr](http://www.konner-sohnen.fr)

---

**Espafia:**

Fabricado bajo licencia y control de DIMAX International GmbH, Flinger Broich 203, 40235 D usseldorf, Alemania.

Importador y representante en Espa a de DIMAX International Poland Ltd, Południowa 8 st,  
05-830 Stara Wieś, Polonia.  
Ensamblado en la Rep blica Popular China.  
amazon@dimaxgroup.com  
[www.konner-sohnen.es](http://www.konner-sohnen.es)

---

**Polska:**

Wyprodukowano na licencji i pod kontrol a DIMAX International GmbH, Flinger Broich 203, 40235 D usseldorf, Niemcy.

Importer i przedstawiciel w Polsce:  
DIMAX International Poland Sp.z o. o. ul. Południowa 8,  
05-830 Stara Wieś, Polska. Zmontowany w CRL.  
amazon@dimaxgroup.com  
[www.konner-sohnen.pl](http://www.konner-sohnen.pl)

---

**Україна:**

Виготовлено за ліцензією та під контролем DIMAX International GmbH, Flinger Broich 203, 40235 Дюссельдорф, Німеччина.

Імпортер та представник в Україні:  
ТОВ "ТЕХНО ТРЕЙД КС" вул. Електротехнічна 47,  
02225, м. Київ, Україна. Змонтовано в КНР  
[www.konner-sohnen.com.ua](http://www.konner-sohnen.com.ua)